

## ELO DE LIGAÇÃO PARA CORRENTE ALLOY " CROSBY "

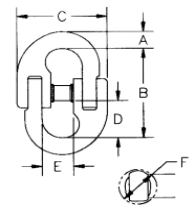

REFERÊNCIA	P/CORRENTE mm	CARGA DE TRABALHO Kg	DIMENSÕES (mm)						PESO Kg
			A	B	C	D	E	F	
FER - ELA07CR	7	1.590	8,38	47,7	44,5	19,8	16,6	14,2	0,140
FER - ELA08CR	8	2.040	10,3	54,0	50,0	22,4	17,5	16,0	0,210
FER - ELA10CR	10	3.220	13,1	63,5	63,5	26,2	22,4	19,1	0,340
FER - ELA13CR	13	5.440	16,3	87,5	82,0	36,6	28,6	23,8	0,680
FER - ELA16CR	16	8.210	19,1	105,0	96,0	44,0	35,7	28,7	1,360
FER - ELA19CR	19	12.840	24,6	126,0	118,0	52,0	41,3	32,5	2,190
FER - ELA22CR	22	15.510	27,0	140,0	143,0	58,5	51,0	36,6	3,410
FER - ELA25CR	26	21.600	31,0	152,0	157,0	63,5	57,0	47,8	4,830

## ELO DE LIGAÇÃO PARA CORRENTE ALLOY

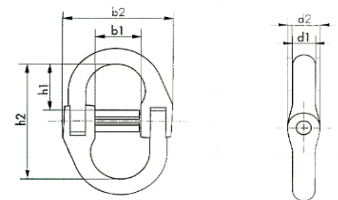

REFERÊNCIA	P/CORRENTE mm	CARGA DE TRABALHO Kg	DIMENSÕES (mm)						PESO Kg
			d1	b2	b1	h1	h2	d2	
FER - ELA07-8	7-8	2.000	8,5	52,8	14,7	23,8	54,0	13,4	0,110
FER - ELA10	10	3.200	10,6	64,7	18,4	28,1	64,8	19,7	0,350
FER - ELA13	13	5.400	13,6	82,0	21,0	37,0	84,9	23,7	0,600
FER - ELA16	16	8.000	17,5	102,8	25,6	47,0	106,1	28,5	1,360
FER - ELA19	19	11.200	21,6	120,1	33,5	56,2	128,1	34,4	1,810
FER - ELA22	22	14.000	27,0	135,0	36,0	60,0	130,0	37,0	2,800
FER - ELA25	26	17.000	31,0	150,0	39,0	65,0	132,0	40,0	4,200

## PEA - PUNÇÃO PARA SACAR PERNOS

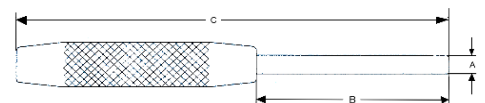

REFERÊNCIA	P/ELOS mm	DIMENSÕES (mm)			PESO Kg
		A	B	C	
FER - PEA07-8	7-8	5,5	60,0	130,0	0,110
FER - PEA10	10	7,0	70,0	180,0	0,270
FER - PEA13	13	8,0	88,0	200,0	0,300
FER - PEA16	16	10,0	100,0	215,0	0,320
FER - PEA19	19	12,0	115,0	228,0	0,360
FER - PEA22	22	15,0	138,0	253,0	0,440
FER - PEA26	26	16,0	160,0	270,0	0,520