

ELO DE ACOPLAMENTO EM AÇO ALLOY

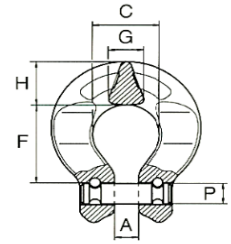

REFERÊNCIA	CARGA DE TRABALHO kg	POR CORRENTE mm	DIMENSÕES mm						PESO kg
			A	C	F	P	G	H	
FER-EAA07-8	2 000	7-8	8,7	24,5	32,0	9,5	11,0	18,5	0,180
FER-EAA10	3 200	10	12,5	32,0	44,0	12,0	14,0	19,2	0,350
FER-EAA13	5 400	13	15,0	40,0	55,0	16,0	17,0	24,5	0,720
FER-EAA16	8 000	16	19,0	50,0	65,5	21,0	22,0	30,0	1,200

GATOS DE PASSAR CORRENTE EM AÇO ALLOY

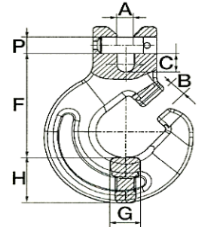

REFERÊNCIA	CARGA DE TRABALHO kg	POR CORRENTE mm	DIMENSÕES mm						PESO kg
			A	B	F	P	G	H	
FER-GFPC07-8	2.000	7-8	9,0	10,0	65,0	10,0	19,0	28,0	0,410
FER-GFPC10	3.200	10	12,5	12,0	80,0	12,0	19,5	32,0	0,700
FER-GFPC13	5.400	13	16,5	16,0	94,0	16,0	24,0	4,0	1,050

PASSADOR COM SAPATILHO EM AÇO ALLOY

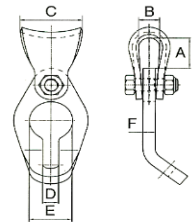

REFERÊNCIA	CARGA DE TRABALHO kg	POR CORRENTE mm	DIMENSÕES mm						PESO kg
			A	C	F	P	G	H	
FER-PCS07-8	2.000	7-8	27,0	18,0	50,0	13,0	35,0	9,5	0,500